

PLAN VIEW

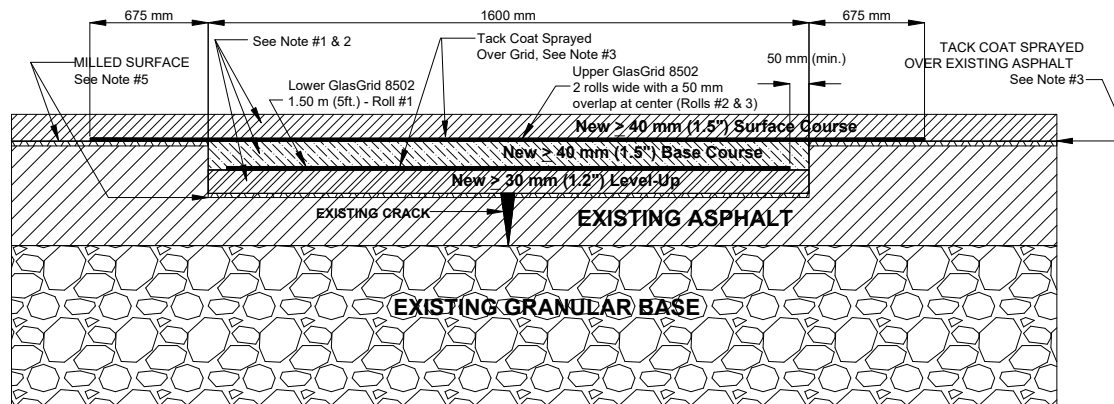

SECTION VIEW

SHRP Pavement Distress Identification

High = any crack with a mean >19mm; or any crack with a mean ≤ 19mm and adjacent moderate to high severity random cracking

Notes:

1. Asphalt to be manufactured and compacted according to state specification and the Asphalt Institute Guidelines.
2. Asphalt to meet requirements for Note 1, and shall provide a smooth clean and dry surface on which to receive GlasGrid®.
3. A tack coat should be selected that will be stable in the environment of construction (e.g. SS-1h or CSS-1h rather than SS-1), if applied below the grid, should be fully cured prior to receiving the grid and paving.
4. CROSS FALL SHOULD ALLOW FOR MINIMUM OVERLAY thickness at the edge of the pavement.
5. Milled surface should be tacked and should be stable to allow the levelling course to be constructed.

Note: In as much as Saint-Gobain Technical Fabrics has no control over installation design, installation workmanship, accessory materials, or conditions of application, Saint-Gobain does not warranty, with respect to the installation or use of the product or any final product into which the product may be incorporated by the purchaser and/or user, the performance or results of any such installation or use. THIS WARRANTY DISCLAIMER INCLUDES ALL IMPLIED WARRANTIES, STATUTORY OR OTHERWISE, INCLUDING THE WARRANTY OF MERCHANTABILITY AND OF FITNESS FOR A PARTICULAR PURPOSE. The purchaser and/or user should perform its own tests to determine the suitability and fitness of the particular purpose desired in any given situation.

Saint-Gobain Technical Fabrics America, Inc.

Typical Detail over High Severity Transverse Cracks

DATE: JULY 6, 2004

DWN BY: JRD

SCALE: NTS

**STANDARD DRWG. NO.
SGTF - 300**

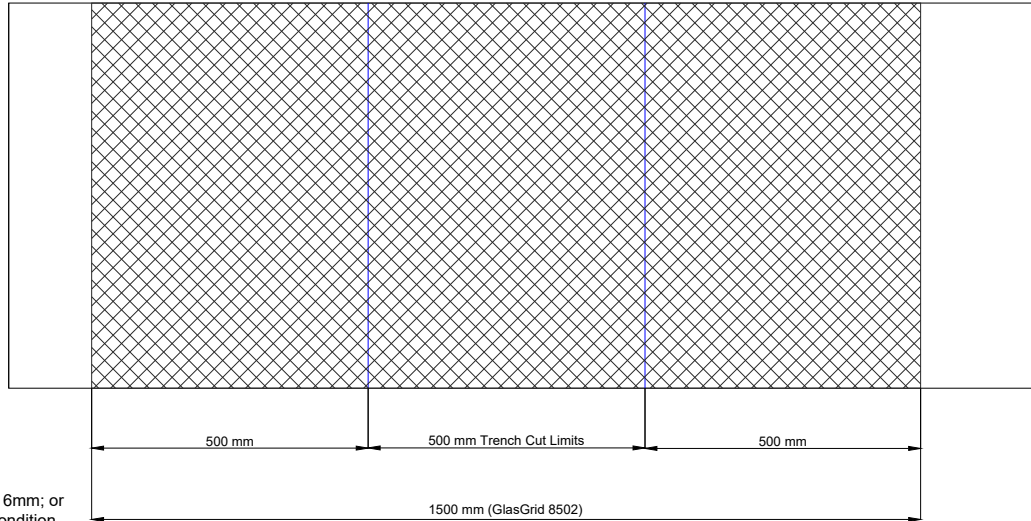

PLAN VIEW

SHRP Pavement Distress Identification

Low = an unsealed crack with a mean width $\leq 6\text{mm}$; or a sealed crack with sealant material in good condition and with a width that cannot be determined

Moderate = any crack with a mean width $> 6\text{mm}$ and $\leq 19\text{mm}$; or any crack with a mean width of $\leq 19\text{mm}$ and adjacent low severity random cracks

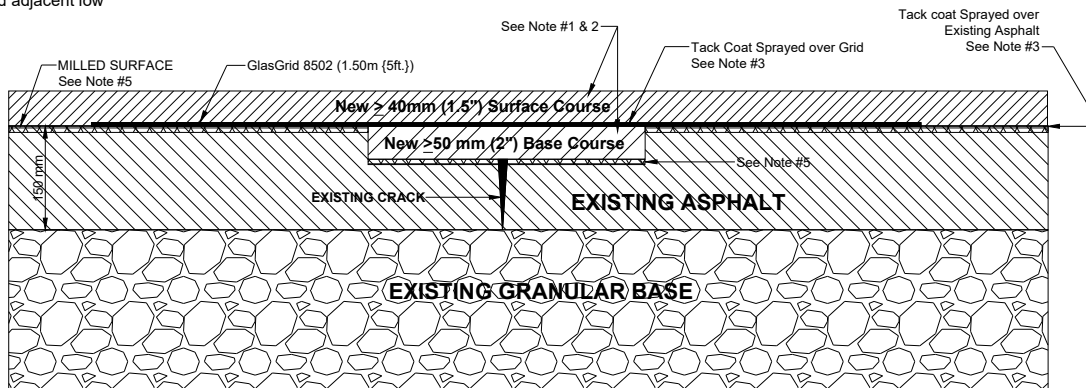

SECTION VIEW

Notes:

- Asphalt to be manufactured and compacted according to state specification and the Asphalt Institute Guidelines.
- Asphalt to meet requirements for Note 1, and shall provide a smooth clean and dry surface on which to receive GlasGrid®.
- A tack coat should be selected that will be stable in the environment of construction (e.g. SS-1h or CSS-1h rather than SS-1), if applied below the grid, should be fully cured prior to receiving the grid and paving.
- CROSS FALL SHOULD ALLOW FOR MINIMUM OVERLAY thickness at the edge of the pavement.
- Milled surface should be tacked and should be stable to allow the levelling course to be constructed.
- CRACKS wider than 6 mm (1/4") need to be sealed with the appropriate sealant.

Note: In as much as Saint-Gobain Technical Fabrics has no control over installation design, installation workmanship, accessory materials, or conditions of application, Saint-Gobain does not warranty, with respect to the installation or use of the product or any final product into which the product may be incorporated by the purchaser and/or user, the performance or results of any such installation or use.

THIS WARRANTY DISCLAIMER INCLUDES ALL IMPLIED WARRANTIES, STATUTORY OR OTHERWISE, INCLUDING THE WARRANTY OF MERCHANTABILITY AND OF FITNESS FOR A PARTICULAR PURPOSE. The purchaser and/or user should perform its own tests to determine the suitability and fitness of the particular purpose desired in any given situation.

Saint-Gobain Technical Fabrics America, Inc.

**Typical Detail Over
Low - Medium Severity Transverse Cracks**

DATE: JULY 6, 2004

DWN BY: JRD

SCALE: NTS

STANDARD DRWG. NO.
SGTF - 301

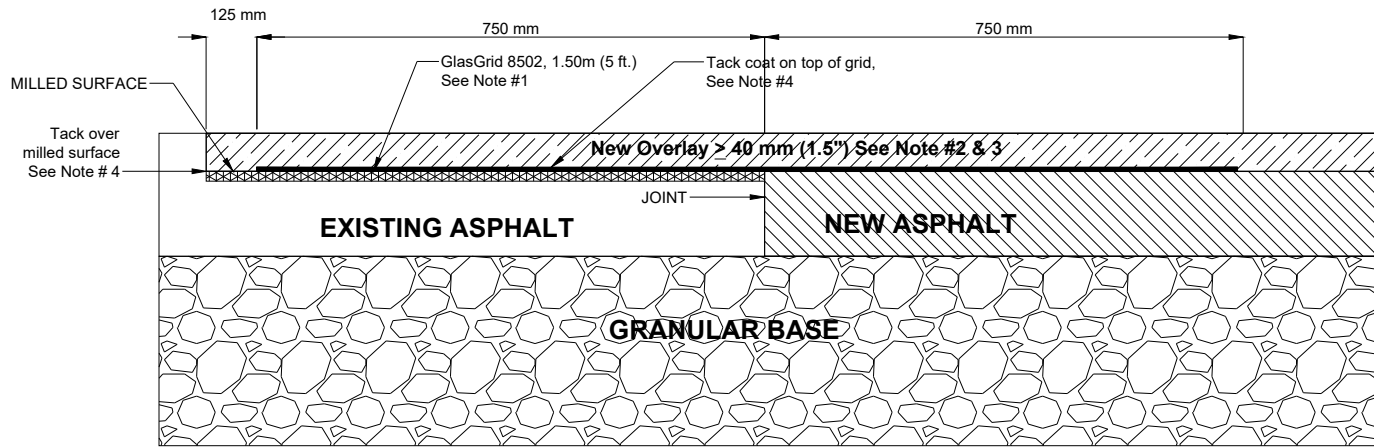

STEP JOINT

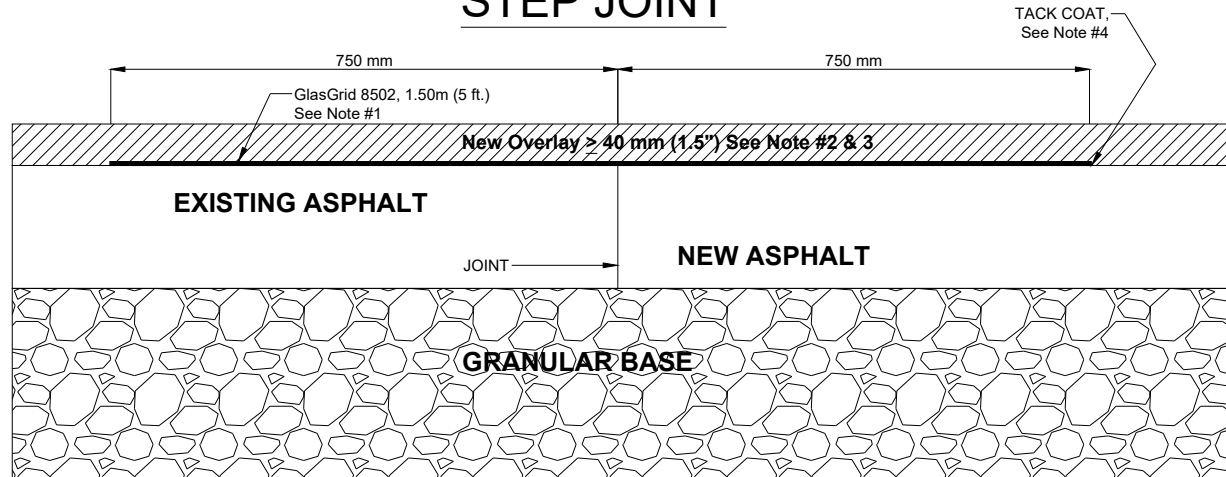

BUTT JOINT

Notes:

1. GlasGrid® 8502/8512 position to be centered over existing pavement limits.
2. Asphalt to be manufactured and compacted according to state specification and the Asphalt Institute Guidelines.
3. Asphalt to meet requirements for Note 3, and shall provide a smooth clean and dry surface on which to receive GlasGrid®.
4. A tack coat should be selected that will be stable in the environment of construction (e.g. SS-1h or CSS-1h rather than SS-1), if applied below the grid, should be fully cured prior to receiving the grid and paving.
5. CROSS FALL SHOULD ALLOW FOR MINIMUM OVERLAY thickness at the edge of the pavement.
6. Milled surface should be tacked.
7. CRACKS wider than 6 mm (1/4") need to be sealed with the appropriate sealant.

Note: In as much as Saint-Gobain Technical Fabrics has no control over installation design, installation workmanship, accessory materials, or conditions of application, Saint-Gobain does not warrant, with respect to the installation or use of the product or any final product into which the product may be incorporated by the purchaser and/or user, the performance or results of any such installation or use.

THIS WARRANTY DISCLAIMER INCLUDES ALL IMPLIED WARRANTIES, STATUTORY OR OTHERWISE, INCLUDING THE WARRANTY OR MERCHANTABILITY AND OF FITNESS FOR A PARTICULAR PURPOSE. The purchaser and/or user should perform its own tests to determine the suitability and fitness of the particular purpose desired in any given situation.

Saint-Gobain Technical Fabrics America, Inc.

Typical Detail Lane-Widening Joints

DATE: JULY 6, 2004
DWN BY: JRD
SCALE: NTS

STANDARD DRWG. NO.
SGTF - 302

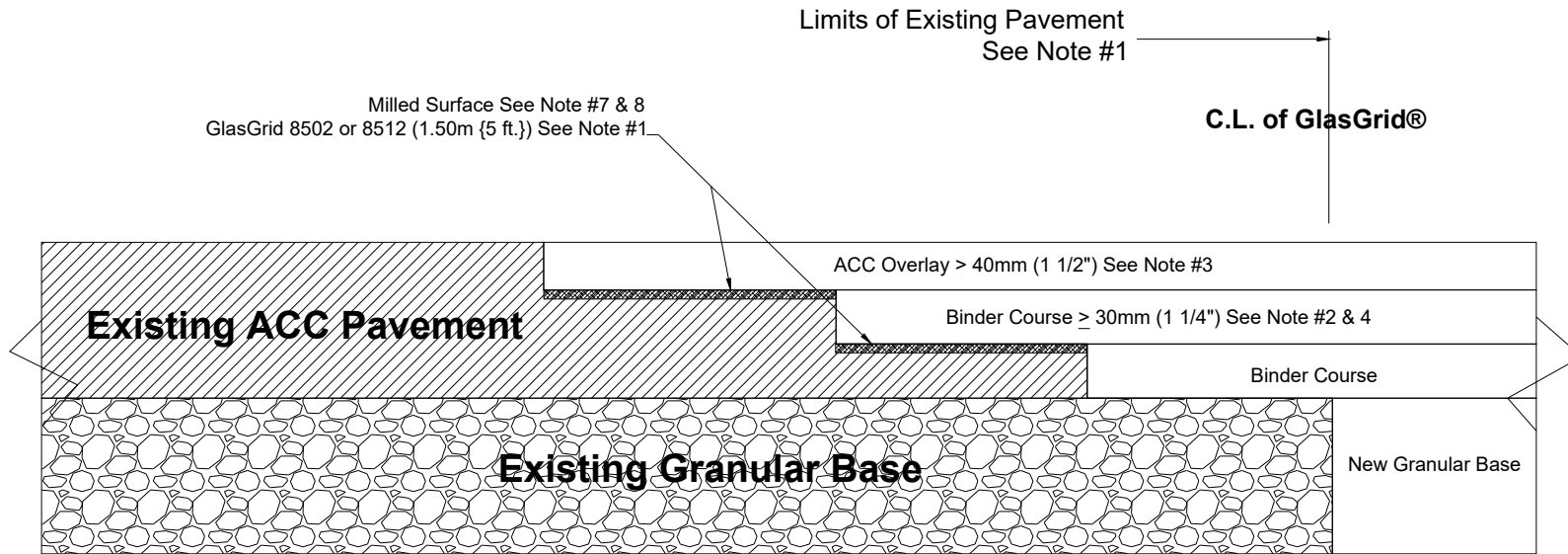

CROSS-SECTION

Notes:

1. GlasGrid® 8502/8512 position to be centered over existing pavement limits.
2. GlasGrid® to be placed on a binder course where the step is $\geq 0.80\text{m}$ (2.6 ft.) away from edge of existing pavement.
3. Asphalt to be manufactured and compacted according to state specification and the Asphalt Institute Guidelines.
4. Asphalt to meet requirements for Note 3, and shall provide a smooth clean and dry surface on which to receive GlasGrid®.
5. A tack coat should be selected that will be stable in the environment of construction (e.g. SS-1h or CSS-1h rather than SS-1), if applied below the grid, should be fully cured prior to receiving the grid and paving.
6. CROSS FALL SHOULD ALLOW FOR MINIMUM OVERLAY thickness at the edge of the pavement.
7. Milled surface should be tacked.
8. CRACKS wider than 6 mm (1/4") need to be sealed with the appropriate sealant.

Note: In as much as Saint-Gobain Technical Fabrics has no control over installation design, installation workmanship, accessory materials, or conditions of application, Saint-Gobain does not warrant, with respect to the installation or use of the product or any final product into which the product may be incorporated by the purchaser and/or user, the performance or results of any such installation or use.

THIS WARRANTY DISCLAIMER INCLUDES ALL IMPLIED WARRANTIES, STATUTORY OR OTHERWISE, INCLUDING THE WARRANTY OR MERCHANTABILITY AND OF FITNESS FOR A PARTICULAR PURPOSE. The purchaser and/or user should perform its own tests to determine the suitability and fitness of the particular purpose desired in any given situation.

Saint-Gobain Technical Fabrics America, Inc.	
TYPICAL DETAIL ROAD WIDENING	
DATE: JULY 5, 2004	STANDARD DRWG. NO. SGTF - 303
DWN BY: JRD	
SCALE: NTS	

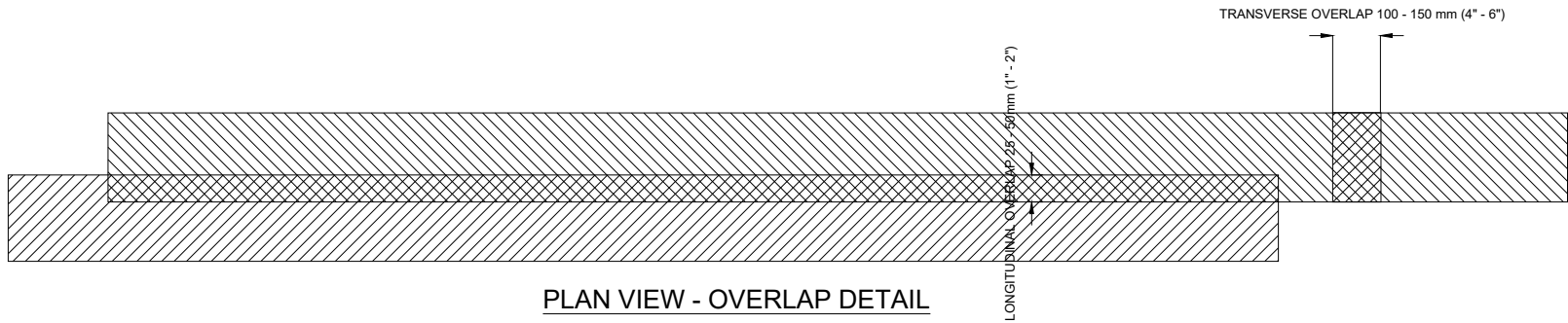

PLAN VIEW - OVERLAP DETAIL

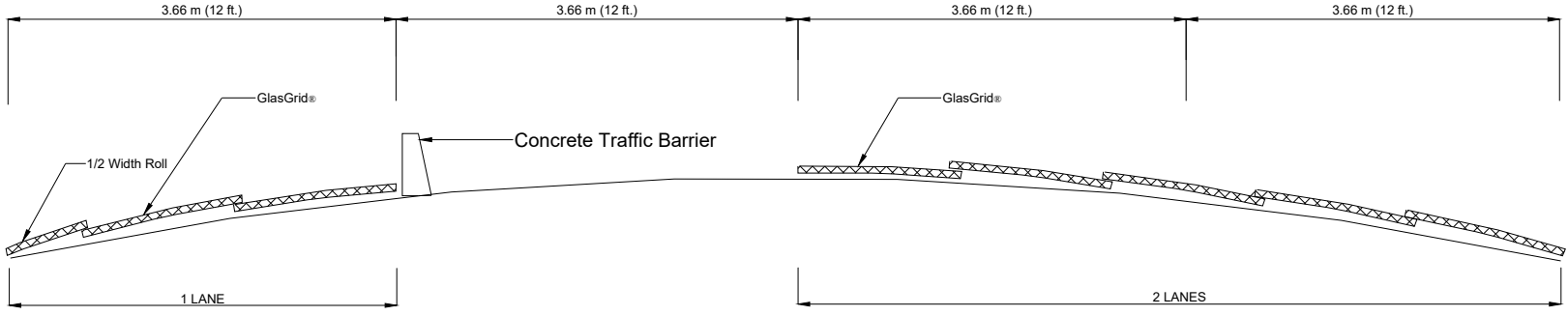

HIGHWAY CROSS-SECTION

- Notes:**
1. When work is restricted to a single lane, 2 full and 1/2 rolls of GlasGrid® is required.
 2. When work can span over 2 lanes, place 5 rolls wide with one centered between the 2 lanes.
 3. Overlaps: Longitudinal = 25 - 50 mm
 Transverse = 100 - 150 mm shingled in the direction of paving.

Note: In as much as Saint-Gobain Technical Fabrics has no control over installation design, installation workmanship, accessory materials, or conditions of application, Saint-Gobain does not warranty, with respect to the installation or use of the product or any final product into which the product may be incorporated by the purchaser and/or user, the performance or results of any such installation or use.

THIS WARRANTY DISCLAIMER INCLUDES ALL IMPLIED WARRANTIES, STATUTORY OR OTHERWISE, INCLUDING THE WARRANTY OR MERCHANTABILITY AND OF FITNESS FOR A PARTICULAR PURPOSE. The purchaser and/or user should perform its own tests to determine the suitability and fitness of the particular purpose desired in any given situation.

Product	Width	Length
8501 & 8511	1.5m (5 ft.)	100m (327 ft.)
8502 & 8512	1.5m (5 ft.)	60m (198 ft.)
8550	1.5m (5 ft.)	150m (492 ft.)

Saint-Gobain Technical Fabrics America, Inc.	
TYPICAL DETAIL OVERLAP DETAIL	
DATE: JULY 5, 2004	STANDARD DRWG. NO. SGTF - 304
DWN BY: JRD	
SCALE: NTS	

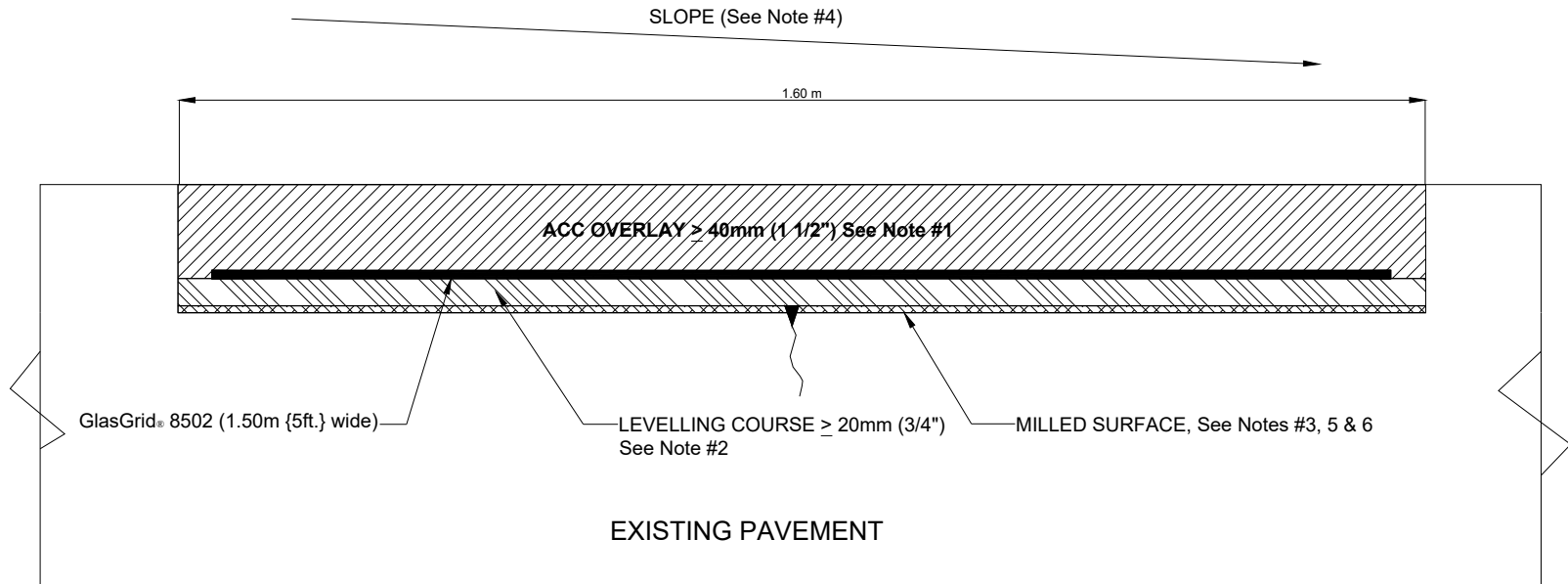

CROSS-SECTION

Notes:

1. Asphalt to be manufactured and compacted according to state specification and the Asphalt Institute Guidelines.
2. Asphalt to meet requirements for Note 1, and shall provide a smooth clean and dry surface on which to receive GlasGrid®.
3. A tack coat should be selected that will be stable in the environment of construction (e.g. SS-1h or CSS-1h rather than SS-1), if applied below the grid, should be fully cured prior to receiving the grid and paving.
4. CROSS FALL SHOULD ALLOW FOR MINIMUM OVERLAY thickness at the edge of the pavement.
5. Milled surface should be tacked and should be stable to allow the levelling course to be constructed.
6. CRACKS wider than 6 mm (1/4") need to be sealed with the appropriate sealant.

Note: In as much as Saint-Gobain Technical Fabrics has no control over installation design, installation workmanship, accessory materials, or conditions of application, Saint-Gobain does not warranty, with respect to the installation or use of the product or any final product into which the product may be incorporated by the purchaser and/or user, the performance or results of any such installation or use.

THIS WARRANTY DISCLAIMER INCLUDES ALL IMPLIED WARRANTIES, STATUTORY OR OTHERWISE, INCLUDING THE WARRANTY OR MERCHANTABILITY AND OF FITNESS FOR A PARTICULAR PURPOSE. The purchaser and/or user should perform its own tests to determine the suitability and fitness of the particular purpose desired in any given situation.

Saint-Gobain Technical Fabrics America, Inc.	
TYPICAL DETAIL DETAILED REPAIR	
DATE: JULY 5, 2004	STANDARD DRWG. NO. SGTF - 305
DWN BY: JRD	
SCALE: NTS	

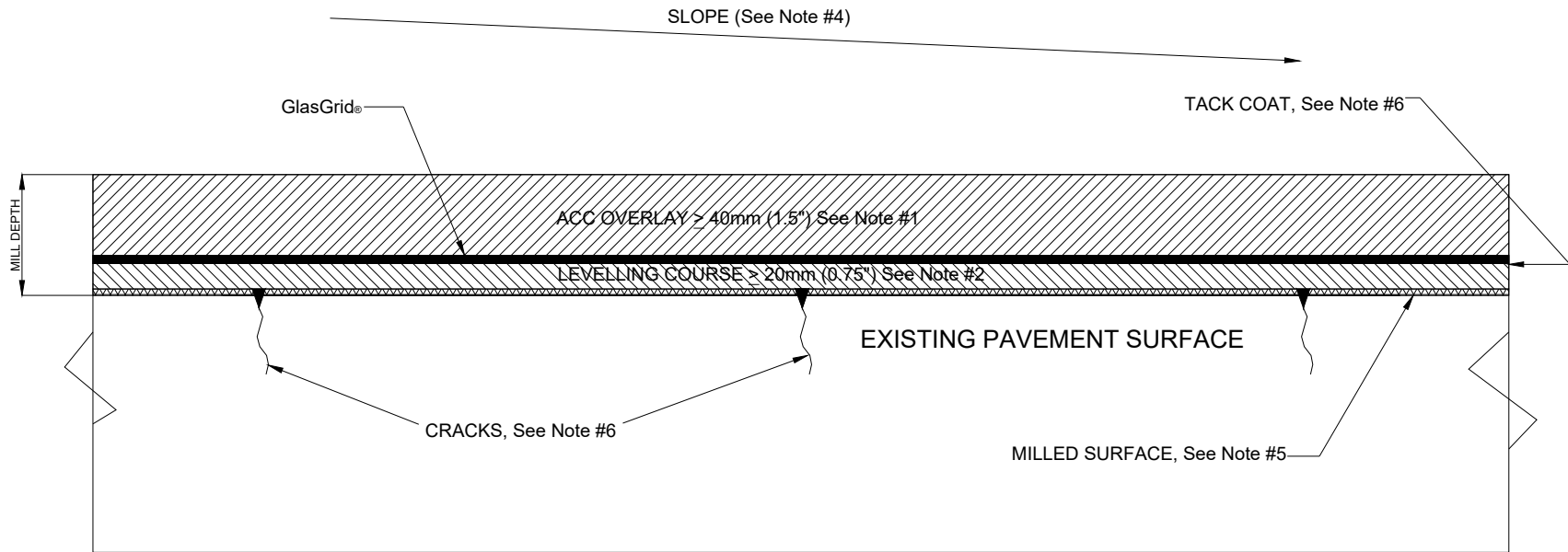

CROSS-SECTION

Notes:

1. Asphalt to be manufactured and compacted according to state specification and the Asphalt Institute Guidelines.
2. Asphalt to meet requirements for Note 1, and shall provide a smooth clean and dry surface on which to receive GlasGrid®.
3. A tack coat should be selected that will be stable in the environment of construction (e.g. SS-1h or CSS-1h rather than SS-1), if applied below the grid, should be fully cured prior to receiving the grid and paving.
4. CROSS FALL SHOULD ALLOW FOR MINIMUM OVERLAY thickness at the edge of the pavement.
5. Milled surface should be tacked and should be stable to allow the levelling course to be constructed.
6. CRACKS wider than 6 mm (1/4") need to be sealed with the appropriate sealant.

Note: In as much as Saint-Gobain Technical Fabrics has no control over installation design, installation workmanship, accessory materials, or conditions of application, Saint-Gobain does not warranty, with respect to the installation or use of the product or any final product into which the product may be incorporated by the purchaser and/or user, the performance or results of any such installation or use.

THIS WARRANTY DISCLAIMER INCLUDES ALL IMPLIED WARRANTIES, STATUTORY OR OTHERWISE, INCLUDING THE WARRANTY OR MERCHANTABILITY AND OF FITNESS FOR A PARTICULAR PURPOSE. The purchaser and/or user should perform its own tests to determine the suitability and fitness of the particular purpose desired in any given situation.

Saint-Gobain Technical Fabrics America, Inc.	
TYPICAL DETAIL FULL WIDTH MILL & FILL	
DATE: JULY 6, 2004	STANDARD DRWG. NO. SGTF - 306
DWN BY: JRD	
SCALE: NTS	